

**5-Way Outlet Shapes, Breakout Boots**

- Helashrink 500 Series, in line, low voltage

Cable breakout boots are designed for insulating and sealing a cable crotch, or conduit system, and provide excellent resistance to abrasion and weathering.



500 Series supplied / fully recovered.



a: Expanded form (supplied)

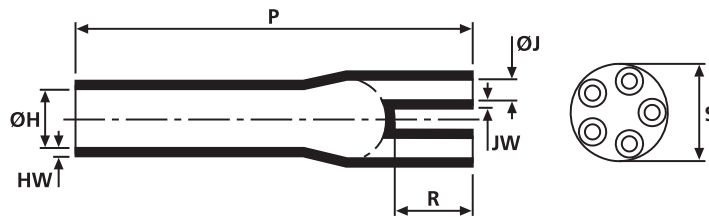

b: Fully recovered form (after heating)

Sizes and Type Table									
Type	ØH min. a	ØH max. b	ØJ min. a	ØJ max. b	P ± 10%	R ± 10%	HW ± 20%	JW ± 20%	S nom
508-1	60.0	24.5	30.0	7.5	180.0	30.0	3.5	3.0	48.0

All dimensions in mm. Subject to technical changes.

Combinations "On request"			
Adhesive	Material		
	B7	G	H
W	√	√	√
W2	√	√	-
V9500	√	√	√
HMT200A	√	√	√
W21	-	-	√
Without Adhesive	√	√	√

Standard combinations	
Article-No.	Type
405-08021	508-1-B7

### 6-Way Outlet Shapes, Breakout Boots

- Helashrink 600 Series, in line, low voltage

Cable breakout boots are designed for insulating and sealing a cable crotch, or conduit system, and provide excellent resistance to abrasion and weathering.



600 Series supplied / fully recovered.



a: Expanded form (supplied)

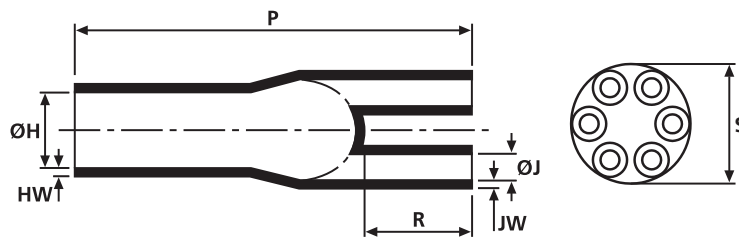

b: Fully recovered form (after heating)

**For Material / Adhesive selection and other information please refer to page 10.**

Sizes and Type Table									
Type	ØH min. a	ØH max. b	ØJ min. a	ØJ max. b	P ± 10%	R ± 10%	HW ± 20%	JW ± 20%	S nom
609-1	30.0	16.0	8.2	4.0	75.0	20.0	2.5	1.5	25.0
609-2	40.0	16.0	12.0	4.0	75.0	20.0	2.5	1.5	25.0
608-1	61.0	36.8	21.0	8.9	152.5	56.5	3.1	3.2	50.0

All dimensions in mm. Subject to technical changes.

Combinations "On request"			
Adhesive	Material		
	B7	G	H
W	√	√	√
W2	√	√	-
V9500	√	√	-
HMT200A	√	√	√
W21	-	-	√
Without Adhesive	√	√	√

Standard combinations	
Article-No.	Type
406-09003	609-1-G
406-09023	609-2-B7
406-08007	608-1-G